

No.	Description/Materials
1	DOLLY - FOAMED PE
2	3" DIA. SWVL. CSTR.-RBR/STL

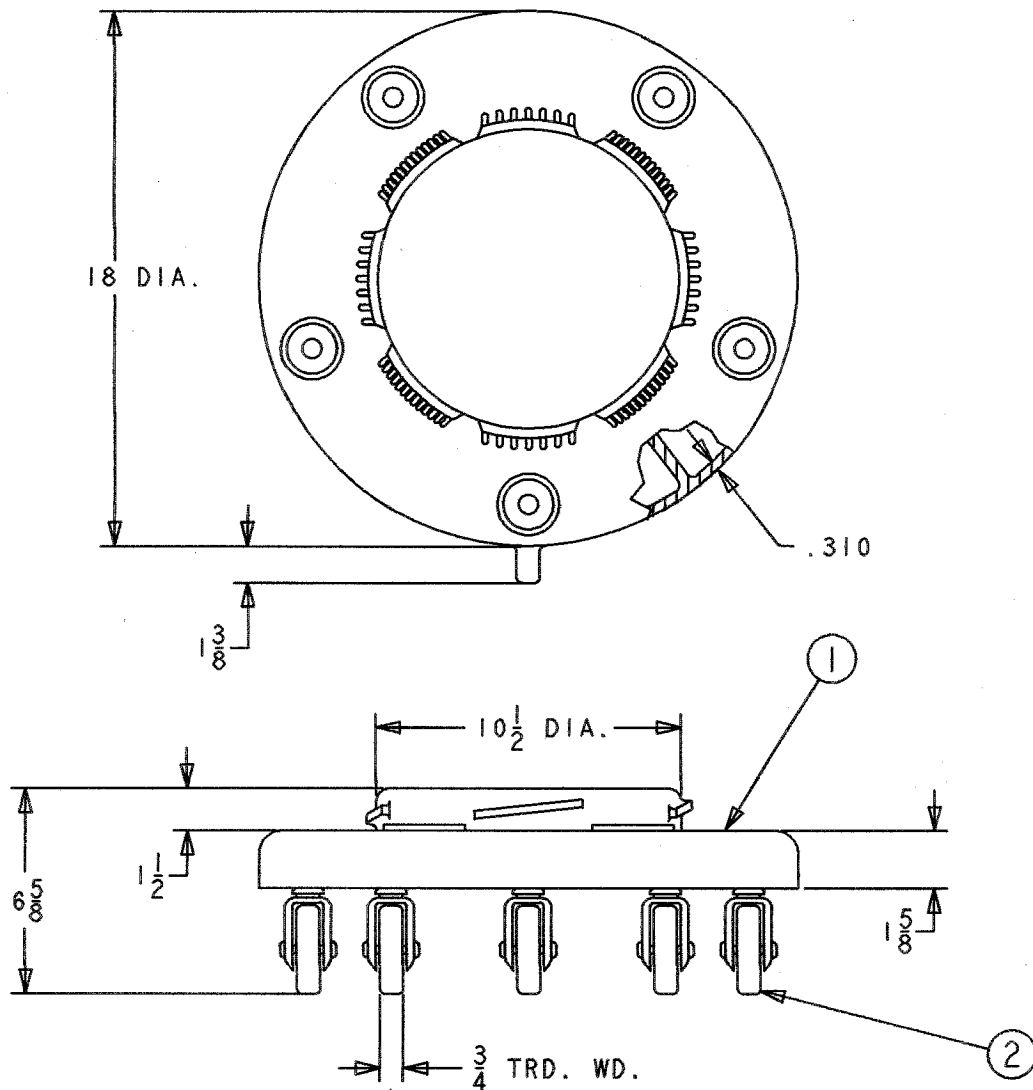

total part wt. 7.0 LBS.

capacity

agency approvals NSF STD. #2 & #21

miscellaneous FITS 20, 32, 44, 55 GAL. CONT.

Product Specifications

Rubbermaid RUBBERMAID
COMMERCIAL
PRODUCTS INC.

product name CONVERSION DOLLY

product no. 2640 revision 4

product no. 2640